

# Series DEC

## Full Round, Dual Pinch, Enclosed Construction, Electric Actuator Operated

- Clog resistant full round opening
- Low pressure drop
- No packing
- Drop tight closure
- High efficiency stainless steel ACME stem for easy operation
- Complete motorized actuator includes starters, power supply, limit switches, auxiliary Hand wheel, push buttons and selector switch
- Valves come fully assembled, calibrated and tested for plug & play operation.

**Applications:** Ideal for abrasive, viscous and corrosive fluids including wastewater, mine slurries, chemicals, cement, pulp stock, powder and pellets.

**Operation:** The DEC is a full round dual pinch valve. The electric motor rotates a bronze nut that drives a pair of pinch bars against the rubber sleeve pinching off flow at centerline.

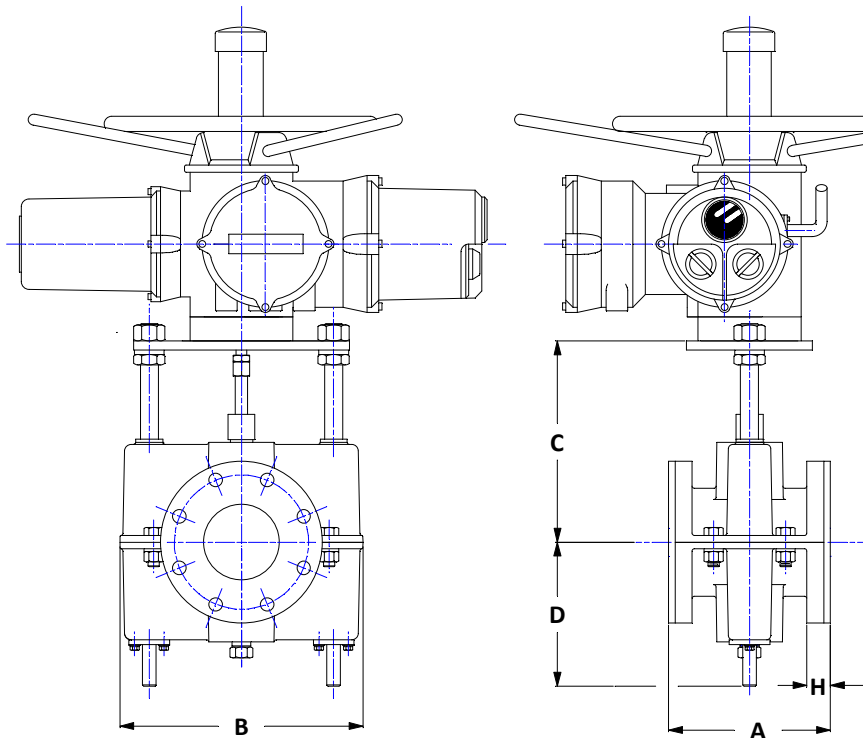
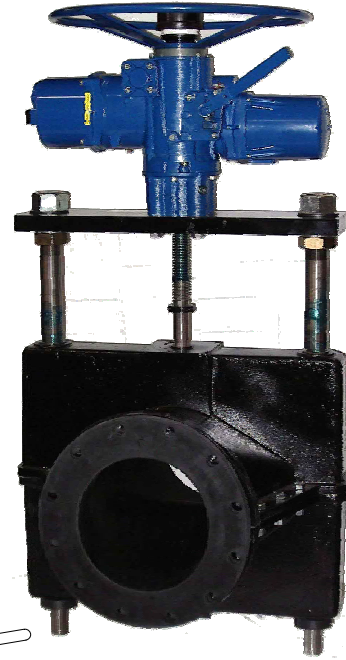

All dimensions are in inches.

### Specifications:

- Flange: ANSI STD 125/150 lbs.
- Housing: Cast iron, ASTM A48, class 35 ( valve sizes up to 10" )  
Ductile iron, ASTM 65-45-12 ( valve sizes 12" and up )
- Stem & guide rods: 303 stainless steel
- Pinch bars: Ductile iron, ASTM 65-45-12

### Options:

- Epoxy paint
- Sleeve elastomer
- ANSI STD 300 lbs flange
- 316 stainless steel
- Secondary containment package
- Positioners
- Limit switches

SIZE	2	3	4	6 , SH.	6 , LG.	8	10	12	14	16	18	20	24	30
A	7.00	8.00	9.00	10.50	17.75	21.37	26.50	29.00	28.00	32.00	36.00	40.00	48.00	60.00
B	8.50	11.00	13.50	20.12		22.75	26.25	32.00	34.37	40.50	43.75	50.50	54.00	78.00
C	10.06	7.37	9.37	12.43		15.37	23.18	28.25	30.10	35.91	38.87	44.39	52.00	70.00
D	5.25	6.56	8.00	11.62		14.62	16.68	20.12	22.18	26.50	28.50	32.15	35.00	40.00
H	1.12	1.31		1.87		1.62	1.81	2.25	2.75	3.37		3.50	4.00	4.50
P Max	200	175	150 psi				100 psi		75 psi					
Wt, lb	40	80	103	250	300	450	650	800	1,000	1,700	2,000	3,000	4,300	N/A